

## grampo VK 002 - padrão

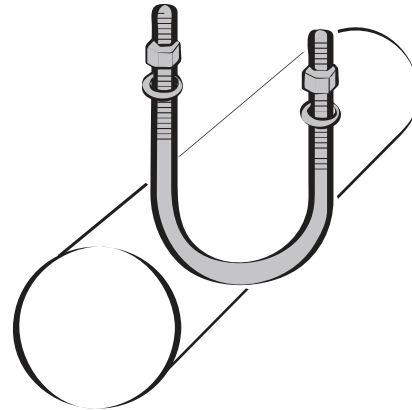
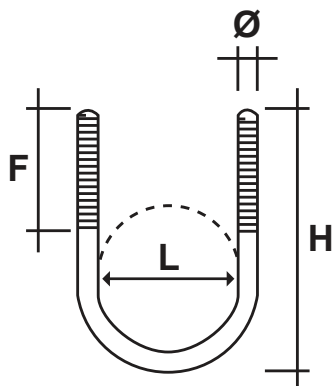

## DN

mm	pol	L mm	H mm	F mm	haste	Ø rosca	QUANT. POR EMBALAGENS
15	1/2"	23.8	69.9	44.5	8.30	3/8"	50
20	3/4"	28.6	77.8	44.5	8.30	3/8"	50
25	1"	34.9	84.1	47.6	8.30	3/8"	50
32	1.1/4"	43.7	88.9	44.5	8.30	3/8"	50
40	1.1/2"	50.8	95.3	44.5	8.30	3/8"	50
50	2"	61.9	119.1	52.4	11.20	1/2"	50
65	2.1/2"	74.6	130.2	52.4	11.20	1/2"	50
80	3"	90.5	144.5	52.4	11.20	1/2"	50
90	3.1/2"	104.9	157.2	52.4	11.20	1/2"	50
100	4"	116.7	176.2	57.2	11.20	1/2"	50
125	5"	142.9	215.9	76.2	14.15	5/8"	Unit.
150	6"	171.5	257.2	95.3	17.10	3/4"	Unit.
200	8"	222.3	308	95.3	17.10	3/4"	Unit.
250	10"	276.2	371.5	101.6	17.10	3/4"	Unit.
300	12"	327	400.1	108	20.20	7/8"	Unit.
350	14"	360.8	442	110	23.10	1"	Unit.
400	16"	412	492	120	23.10	1"	Unit.